

# Face Milling Cutter 45°

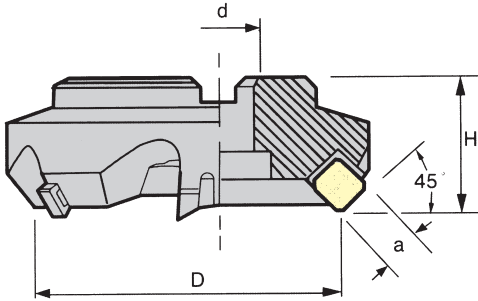

45°



※ All inserts are floating price.  
Contact us before ordering from F1~F45

ORDER NO.	D	d $\varnothing$	INCH METRIC	H	BLADE	WEIGHT(kg)	CODE NO.
SE545-3	80	25.4	27	50	5	2.1	6001-001I
			27				6001-001M
SE545-4	100	31.75	32	55	5	3.5	6001-002I
			32				6001-002M
SE545-5	125	38.1	40	60	6	5.1	6001-003I
			40				6001-003M
SE545-6	160	50.8	40	60	8	7.1	6001-004I
			40				6001-004M
SE545-8	200	47.625	60	60	10	10.4	6001-005I
			60				6001-005M
SE545-10	250	47.625	60	60	12	16.8	6001-006I
			60				6001-006M
SE545-12	300	47.625	60	60	14	27	6001-007I
			60				6001-007M
SE445-3	80	25.4	27	50	5	2.1	6001-020I
			27				6001-020M
SE445-4	100	31.75	32	55	5	3.2	6001-021I
			32				6001-021M
SE445-5	125	38.1	40	60	6	4.7	6001-022I
			40				6001-022M
SE445-6	160	50.8	40	60	8	7.3	6001-023I
			40				6001-023M
SE445-8	200	47.625	60	60	10	9.6	6001-024I
			60				6001-024M
SE445-10	250	47.625	60	60	12	16.7	6001-025I
			60				6001-025M
SE445-12	300	47.625	60	60	14	25.8	6001-026I
			60				6001-026M

## PARTS

SCR-CL5/16	CL-S	SCR-ST-S4	ST-S	WRN-M4T

## INSERT

545 HEAVY DUTY		445 LIGHT DUTY	
SEKN-1504		SEKN-1203	

# Face Milling Cutter 65°

65°

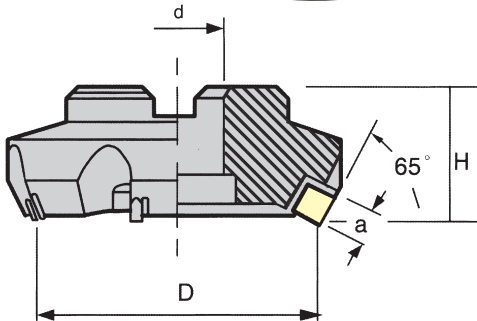

ORDER NO.	D	d $\varnothing$	INCH METRIC	H	BLADE	WEIGHT(kg)	CODE NO.
SP535-3	80	25.4	27	50	5	2.1	6001-040I
			27				6001-040M
SP535-4	100	31.75	32	55	5	3.3	6001-041I
			32				6001-041M
SP535-5	125	38.1	40	60	6	5.6	6001-042I
			40				6001-042M
SP535-6	160	50.8	40	60	8	7.4	6001-043I
			40				6001-043M
SP535-8	200	47.625	60	60	10	10.2	6001-044I
			60				6001-044M
SP535-10	250	47.625	60	60	12	17.5	6001-045I
			60				6001-045M
SP535-12	300	47.625	60	60	14	26.8	6001-046I
			60				6001-046M
SP435-3	80	25.4	27	50	5	2.1	6001-070I
			27				6001-070M
SP435-4	100	31.75	32	55	5	3.3	6001-071I
			32				6001-071M
SP435-5	125	38.1	40	60	6	5.5	6001-072I
			40				6001-072M
SP435-6	160	50.8	40	60	8	7.8	6001-073I
			40				6001-073M
SP435-8	200	47.625	60	60	10	10.1	6001-074I
			60				6001-074M
SP435-10	250	47.625	60	60	12	17.5	6001-075I
			60				6001-075M
SP435-12	300	47.625	60	60	14	26.8	6001-076I
			60				6001-076M

## PARTS

SCR-CL5/16	CL-S	SCR-ST-S4	ST-S	WRN-M4T

## INSERT

535 HEAVY DUTY		435 LIGHT DUTY	
SPKN-1504		SPKN-1204	